



## APARTMENT BLOCK "B"

Floor plans

Jaunā Mežaparka iela 36, Rīga

The two low-rise apartment buildings and joint underground parking area are compact in their design. The use of glass and terraces allows the inhabitants to enjoy the green vista of Mežaparks. The designer, Vladimir Arsene, is an internationally recognized architect whose designs reflect the world's latest architectural trends.

Facades of the building expose exterior finishes typical of the location - wood and high quality plaster finishes. The bright, airy and thoughtfully designed apartments will satisfy even the most fussy purchaser.

# LAYOUT OF THE 1ST FLOOR BLOCK B

JAUNĀ MEŽAPARKA IEĻA



### APARTMENT No.12/ ROOMS: 2

1. ENTRANCE HALL	5.60
2. LIVING/ DINING ROOM	25.00
3. KITCHEN	6.40
4. BEDROOM	14.00
5. BEDROOM	18.10
6. BATHROOM	4.50
7. BATHROOM	4.70
8. TERRACE	11.90

TOTAL INDOOR AREA	78.30
OUTDOOR AREA	11.90

### APARTMENT No.15/ ROOMS: 2

1. ENTRANCE HALL	6.20
2. LIVING/ DINING ROOM	23.70
3. KITCHEN	6.50
4. BEDROOM	14.90
5. BEDROOM	18.40
6. BATHROOM	4.50
7. BATHROOM	4.60
8. TERRACE	14.70
9. TERRACE	8.10
10. TERRACE	10.30

TOTAL INDOOR AREA	78.80
OUTDOOR AREA	33.10

### APARTMENT No.13/ ROOMS: 2

1. ENTRANCE HALL	5.40
2. LIVING/ DINING ROOM	33.40
3. KITCHEN	8.20
4. LAUNDRY ROOM	3.50
5. BEDROOM	18.20
6. WALK-IN CLOSET	4.50
7. BATHROOM	4.80
8. TERRACE	19.90

TOTAL INDOOR AREA	78.00
OUTDOOR AREA	19.90

### APARTMENT No.16/ ROOMS: 2

1. ENTRANCE HALL	5.20
2. LIVING/ DINING ROOM	35.00
3. KITCHEN	7.50
4. BEDROOM	12.60
5. BEDROOM	18.40
6. BATHROOM	4.60
7. BATHROOM	4.10
8. TERRACE	22.40

TOTAL INDOOR AREA	87.40
OUTDOOR AREA	22.40

### APARTMENT No.14/ ROOMS: 2

1. ENTRANCE HALL	8.80
2. LIVING ROOM	20.80
3. KITCHEN	6.00
4. LAUNDRY ROOM	1.90
5. BEDROOM	17.40
6. BATHROOM	5.30

TOTAL INDOOR AREA	60.00
-------------------	-------

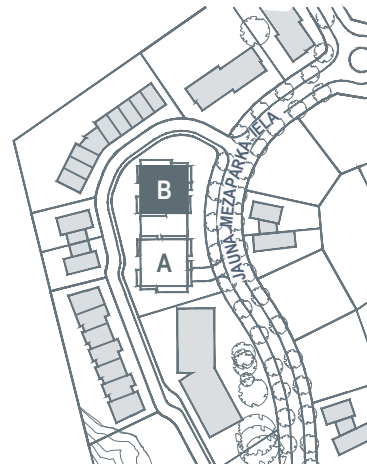

# LAYOUT OF THE 2ND FLOOR BLOCK B

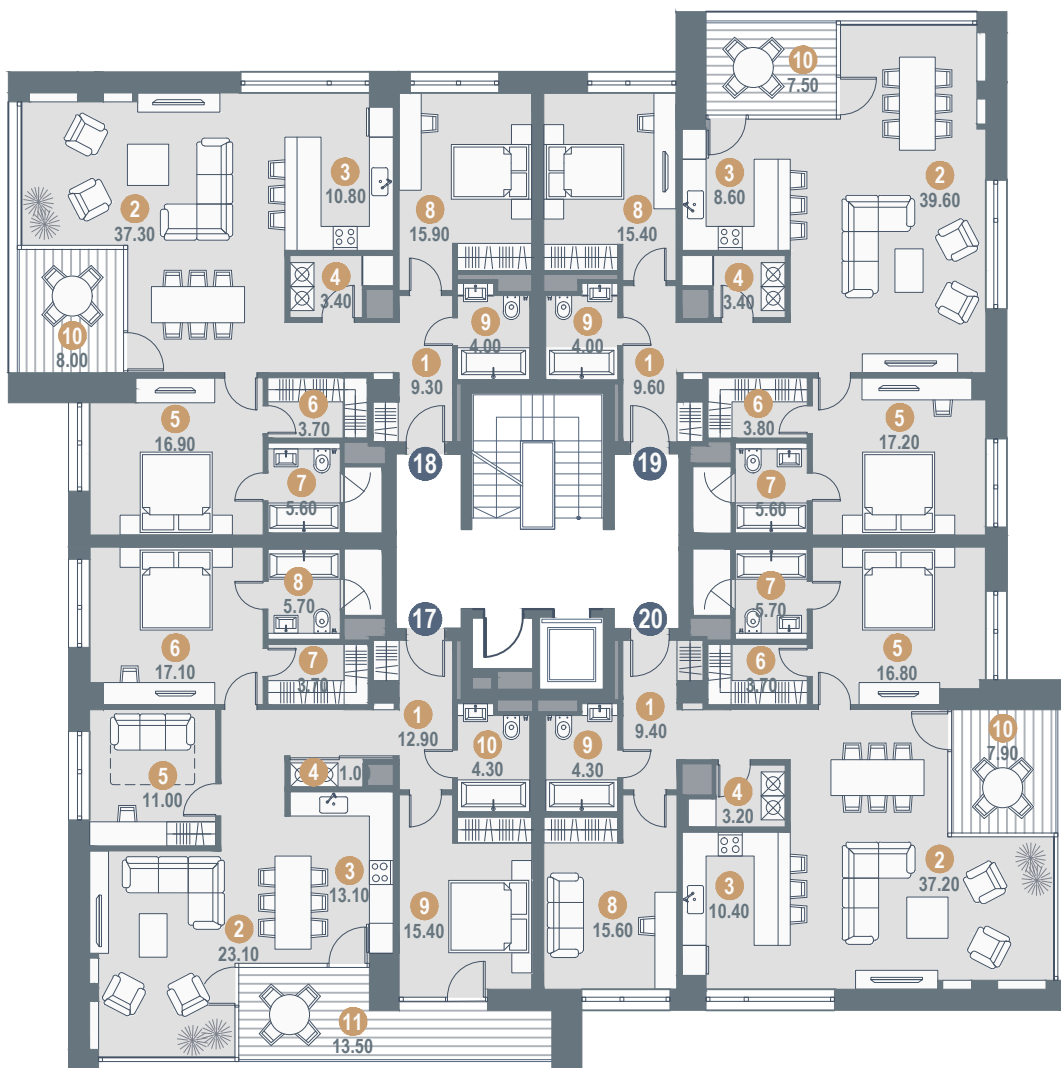

JAUNĀ MEŽAPARKA IELA

0 1 2 3 4 5m



### APARTMENT No.17/ ROOMS: 3

1. ENTRANCE HALL	12.90
2. LIVING/ DINING ROOM	23.10
3. KITCHEN	12.60
4. LAUNDRY ROOM	1.00
5. BEDROOM	11.00
6. BEDROOM	17.10
7. WALK-IN CLOSET	3.70
8. BATHROOM	5.50
9. BEDROOM	14.40
10. BATHROOM	4.30
11. TERRACE	13.50

TOTAL INDOOR AREA	106.60
OUTDOOR AREA	13.50

### APARTMENT No.19/ ROOMS: 3

1. ENTRANCE HALL	9.60
2. LIVING/ DINING ROOM	39.60
3. KITCHEN	8.90
4. LAUNDRY ROOM	3.40
5. BEDROOM	17.20
6. WALK-IN CLOSET	3.80
7. BATHROOM	5.60
8. BEDROOM	15.40
9. BATHROOM	4.00
10. TERRACE	7.50

TOTAL INDOOR AREA	107.20
OUTDOOR AREA	7.50

### APARTMENT No.18/ ROOMS: 3

1. ENTRANCE HALL	9.30
2. LIVING/ DINING ROOM	37.30
3. KITCHEN	10.80
4. LAUNDRY ROOM	3.40
5. BEDROOM	16.90
6. WALK-IN CLOSET	3.70
7. BATHROOM	5.60
8. BEDROOM	15.90
9. BATHROOM	4.00
10. TERRACE	8.00

TOTAL INDOOR AREA	106.90
OUTDOOR AREA	8.00

### APARTMENT No.20/ ROOMS: 3

1. ENTRANCE HALL	9.40
2. LIVING/ DINING ROOM	37.20
3. KITCHEN	10.40
4. LAUNDRY ROOM	3.20
5. BEDROOM	16.80
6. WALK-IN CLOSET	3.70
7. BATHROOM	5.70
8. BEDROOM	15.60
9. BATHROOM	4.30
10. TERRACE	7.90

TOTAL INDOOR AREA	106.30
OUTDOOR AREA	7.90

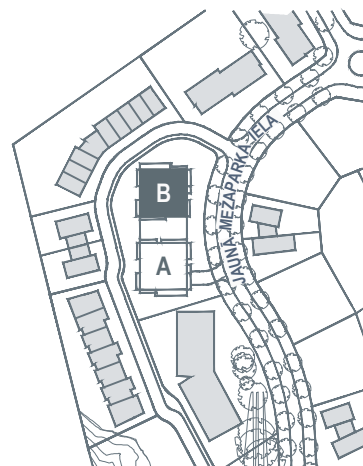

## LAYOUT OF THE 3RD FLOOR BLOCK B



JAUNĀ MEŽAPARKA IELA

0 1 2 3 4 5m



### APARTMENT No.21/ ROOMS: 3

1. ENTRANCE HALL	14.90
2. LIVING/ DINING ROOM	26.80
3. KITCHEN	7.00
4. BATHROOM	4.70
5. BEDROOM	15.30
6. WALK-IN CLOSET	3.50
7. LAUNDRY ROOM	2.70
8. WALK-IN CLOSET	6.70
9. BATHROOM	8.70
10. BEDROOM	21.50
11. TERRACE	87.30
TOTAL INDOOR AREA	111.80
OUTDOOR AREA	87.30

### APARTMENT No.22/ ROOMS: 4

1. ENTRANCE HALL	15.80
2. LIVING/ DINING ROOM	32.70
3. KITCHEN	10.60
4. LAUNDRY ROOM	1.60
5. BATHROOM	5.40
6. OFFICE	16.10
7. BEDROOM	14.80
8. BATHROOM	3.80
9. BEDROOM	22.80
10. WALK-IN CLOSET	8.10
11. BATHROOM	11.50
12. TERRACE	102.50
TOTAL INDOOR AREA	143.20
OUTDOOR AREA	102.50

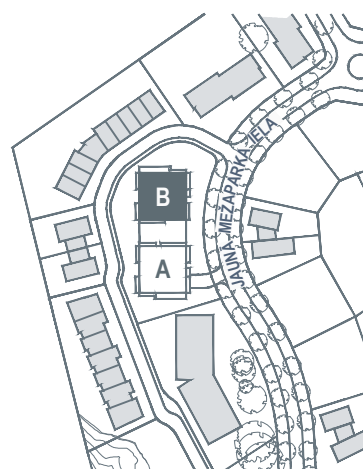



# BASEMENT PLAN BLOCKS A, B

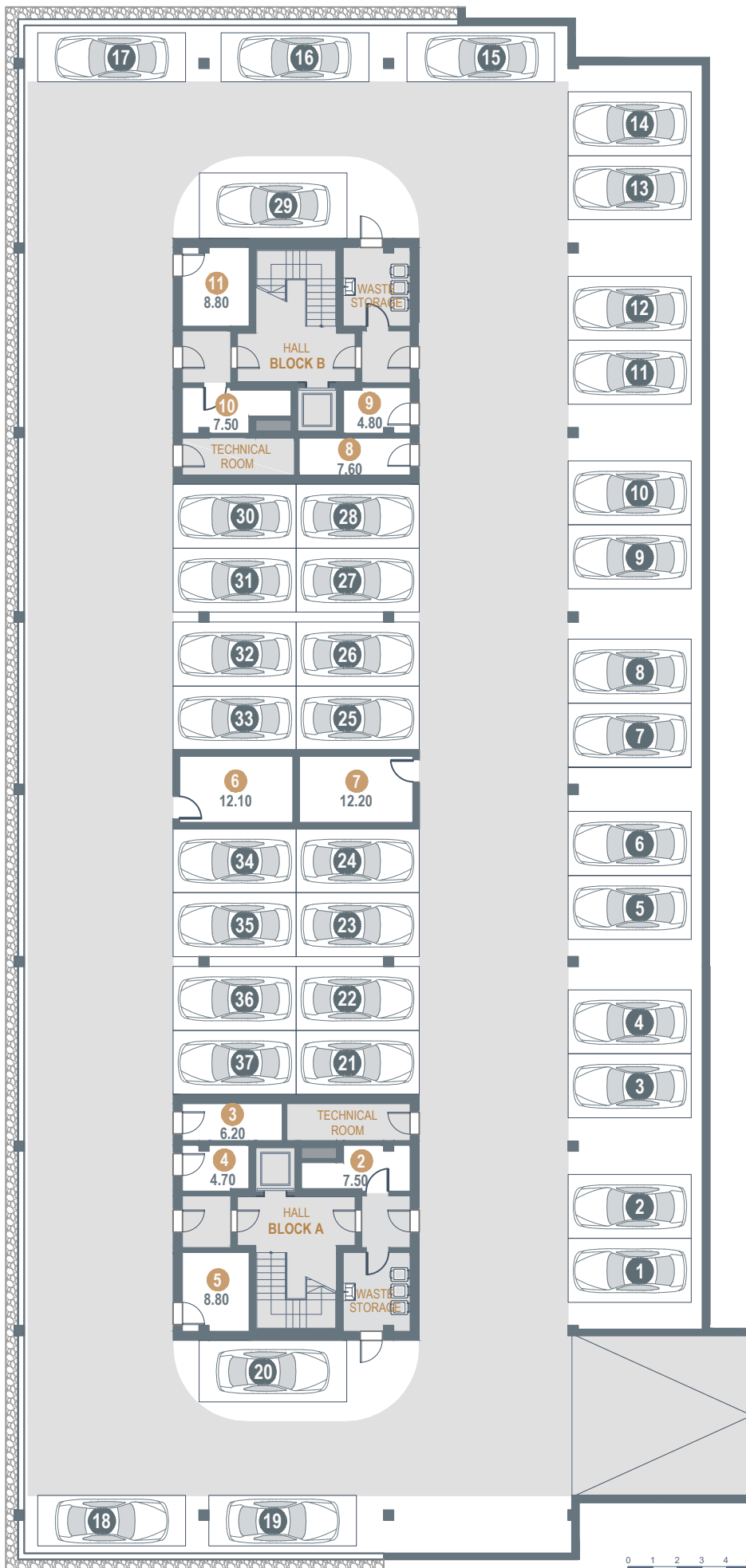

## UNDERGROUND PARKING

2. STORAGE	7.70
3. STORAGE	6.20
4. STORAGE	4.70
5. STORAGE	8.80
6. STORAGE	12.10
7. STORAGE	12.20
8. STORAGE	7.60
9. STORAGE	4.80
10. STORAGE	7.50
11. STORAGE	8.80

JAUNĀ MEŽAPARKA IEĻA

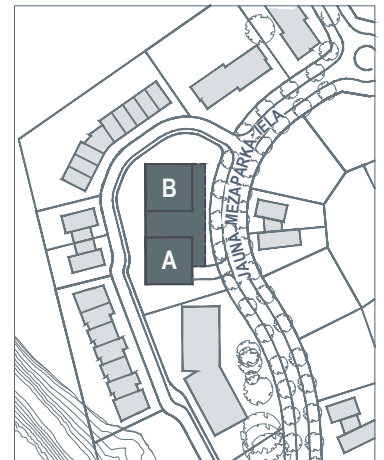

0 1 2 3 4 5m

# INFRASTRUCTURE



24/7



Landscaped  
territory

24 hour  
surveillance

Recreation  
zones with  
benches

Paved and  
lighted  
streets and  
sidewalks

City sewage  
and water

Individual  
gas boiler  
house

City  
electricity  
supply  
(16kW/25A)

Optical  
internet



“Mežaparka Rezidences” occupies a 31 ha large well-developed territory designed as a harmonious extension of the old Mežaparks.

The concept is designed to create a beautifully landscaped environment with full infrastructure accommodating villas, twin- villas, row houses and apartment buildings designed by well-known Latvian and foreign architects. Construction of the 1st stage infrastructure has been completed.

Pedestrian walkways and streets have been paved and illuminated, recreational areas with benches have been created. The territory is surveilled 24 h/day. All the necessary amenities have been provided - water supply and sewage, gas and electricity.

The individually developed house designs shall conform to the general concept of the project to ensure the architectural harmony of the entire project.